

ZKR Versatile

Pull-Cord Call Unit

Pull-Cord Call Unit

The Pull-cord Call Unit is used in patient bathrooms or similar areas. There is a backlit cancel button and an emergency call pull-cord on the unit. In an emergency, a patient pulls the cord making an emergency call.

This appears as a WC Emergency Call on the Nurse Control Panel. The system gives priority to WC Emergency calls and they appear before other calls.

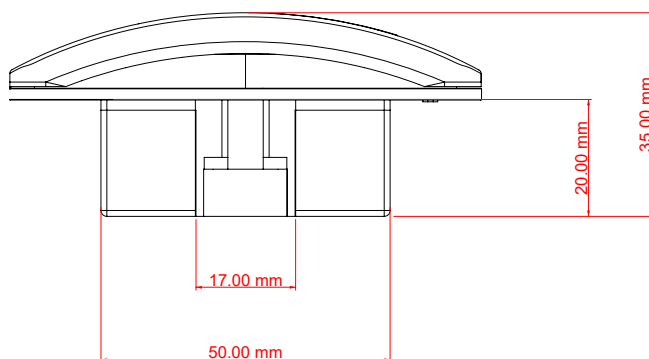
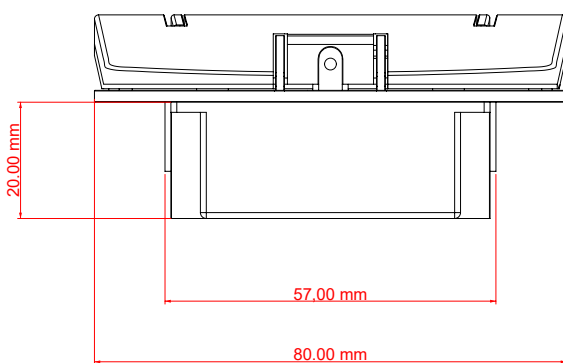

Technical specification

ZKRUNCIPWC10100

Weight (g)	56 gr.
Width (mm)	80 mm.
Depth (mm)	35 mm.
Height (mm)	80 mm.
Rope Durability	Max 30kg
Operating temperature / Humidity	-10°C +60°C / % 30 %80 RH
Material	PC-ABS-FR
Buzzer speaker	2400Hz 65 dB
Color	White
Communication	RS 485
Input Connection	1 RJ 45